

BMW S1000XR '20-

M O U N T I N G I N S T R U C T I O N S

REF 20447

TOURING SCREEN



TORX
T25

ALLEN
Nº 3

ID	PIEZA/PART	DESCRIPCIÓN	DESCRIPTION	QTY	REF
1		Cúpula Touring	Touring screen	1	10798F/H/N/WM3
2		Soporte derecho	Right support	1	SOPOR2P4-R20447
3		Soporte izquierdo	Left support	1	SOPOR2P4-L20447
4		Silentblock Ø9xØ6x8mm	Ø9xØ6x8mm silentblock	4	AROPASACABLES-3
5		Casquillo con valona Ø12xØ6,8x7,3mm	Ø12xØ6,8x7,3mmmm bush with flange	4	CASQUI-1A---750
6		Tornillo Allen M5X16 Ø11 ISO 7380	M5X16 Ø11 ISO 7380 Allen screw	4	TORNI-I7380-493
7		Tornillo Allen M5X11 Ø11 ISO 7380	M5X11 Ø11 ISO 7380 Allen screw	4	TORNI-AI---520
8		Tapón tornillo Allen M5 ISO 7980	M5 ISO 7980 Allen cap screw	4	TAPON-----85

BMW S1000XR '20-

INSTRUCCIONES DE MONTAJE - MOUNTING INSTRUCTIONS - MONTAGEANLEITUNG

1

DISASSEMBLY
DESMONTAJE

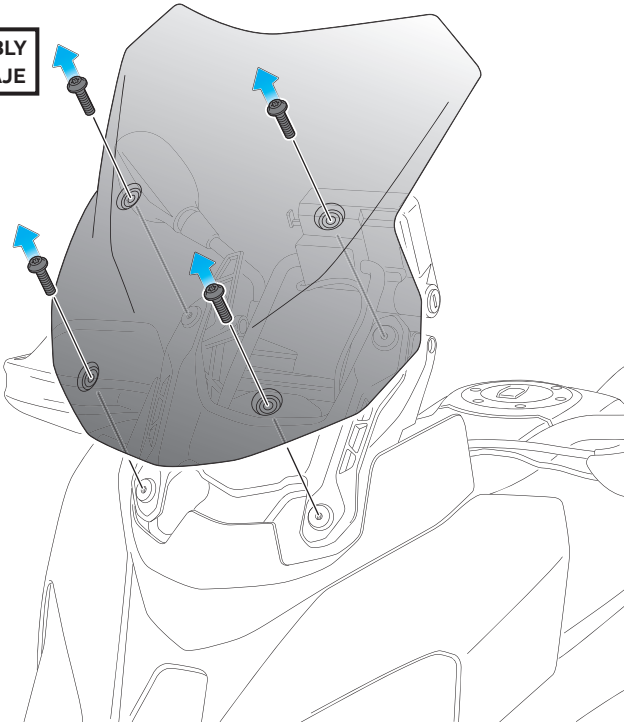

2

ASSEMBLY
MONTAJE

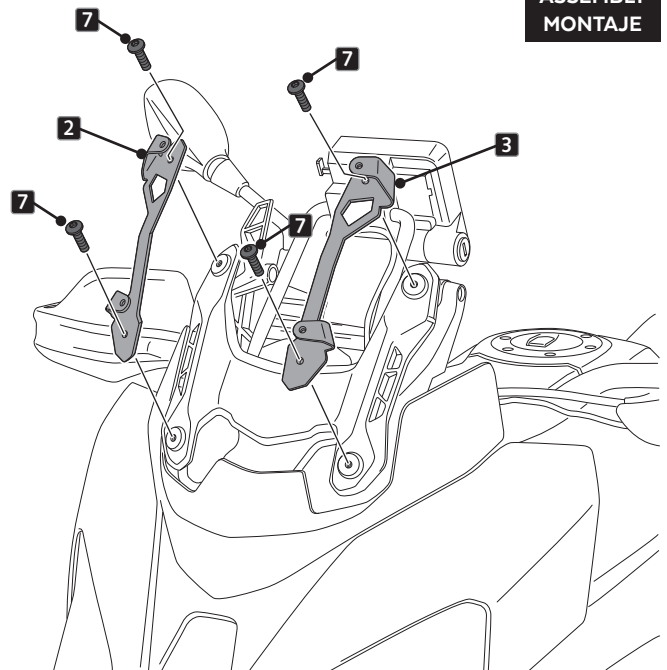

3

ASSEMBLY
MONTAJE

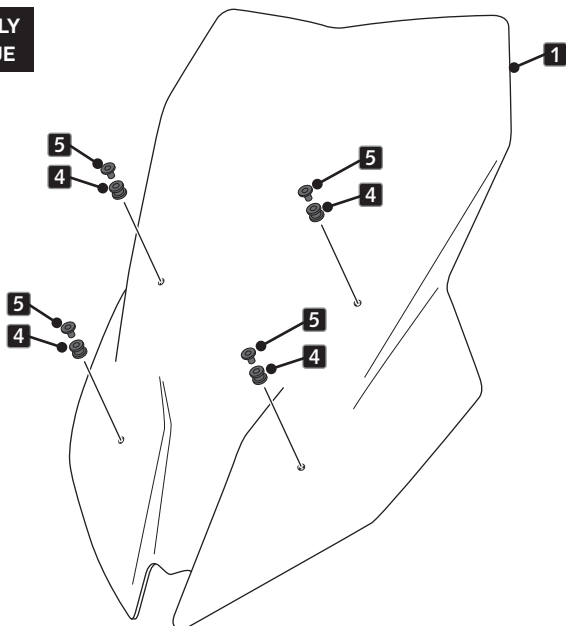

4

ASSEMBLY
MONTAJE

